

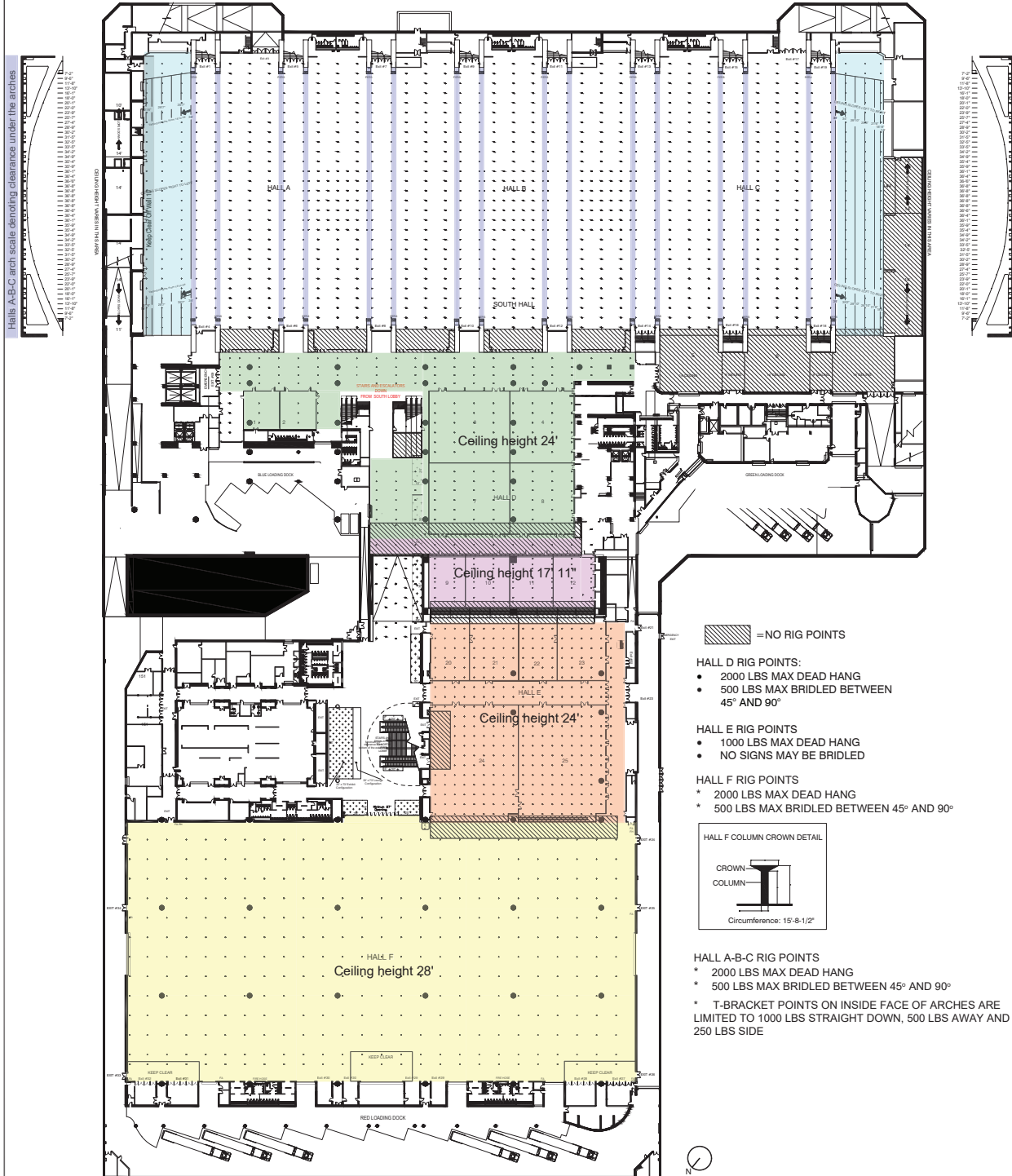

Ceiling height in halls A-B-C between the arches is 38'.
 The light blue lines indicate the arch locations - use the arch scale on side of the plan to determine the clearance under the arches.
 On the far left and far right the ceiling slopes - see plan for details.



-  = NO RIG POINTS
 - HALL D RIG POINTS:**
 - 2000 LBS MAX DEAD HANG
 - 500 LBS MAX BRIDLED BETWEEN 45° AND 90°
 - HALL E RIG POINTS**
 - 1000 LBS MAX DEAD HANG
 - NO SIGNS MAY BE BRIDLED
 - HALL F RIG POINTS**
 - * 2000 LBS MAX DEAD HANG
 - * 500 LBS MAX BRIDLED BETWEEN 45° AND 90°
- HALL F COLUMN CROWN DETAIL**

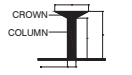

CROWN
COLUMN
Circumference: 15'-8-1/2"
- HALL A-B-C RIG POINTS**
 - * 2000 LBS MAX DEAD HANG
 - * 500 LBS MAX BRIDLED BETWEEN 45° AND 90°
 - * T-BRACKET POINTS ON INSIDE FACE OF ARCHES ARE LIMITED TO 1000 LBS STRAIGHT DOWN, 500 LBS AWAY AND 250 LBS SIDE

Disclaimer: Information provided herein is subject to change based on final approved construction plans and construction timeline.

MOSCOE CENTER

LOWER CONCOURSE, HALL D, NORTH AND SOUTH HALLS, MOSCOE CONVENTION CENTER, SAN FRANCISCO, CA